

PRINETO Underfloor heating systems

Overview - Thin bed systems

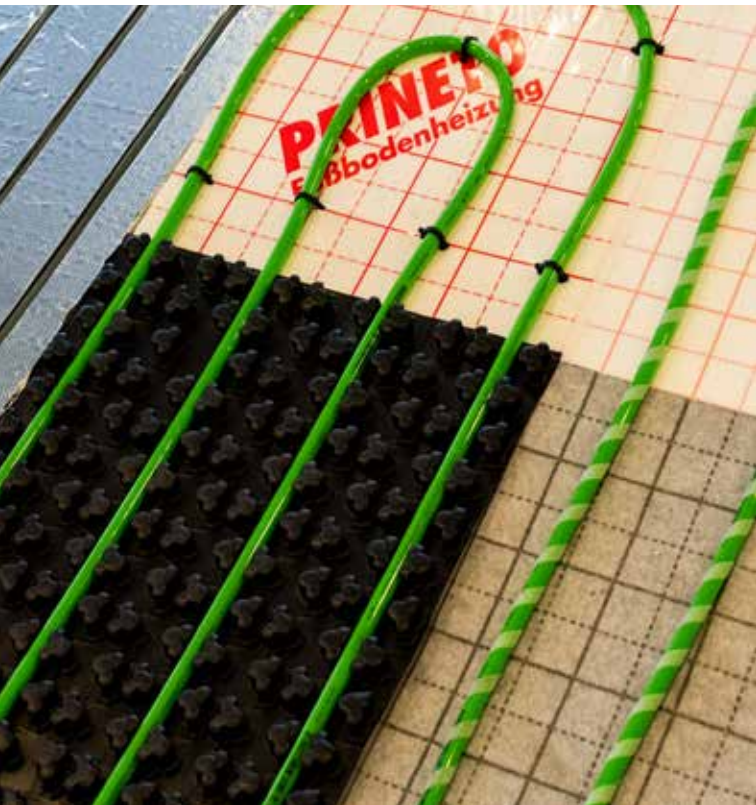

PRINETO Underfloor heating systems

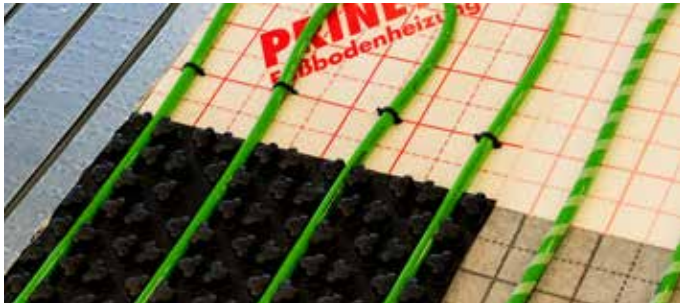

Whether wet or dry installation, knobby board or fixing rail: with IVT modular PRINETO Surface Heating Systems is everything possible - even cooling of buildings. Especially the IVT self-crosslinking PRINETO Ecoflex Underfloor Heating Pipes, green-linked, made of polyethylene PE-HDS, are highly convenient in use.



- Wet- and dry laying systems



- Tool-free laying installation



- Self-adhesive PRINETO tacker foil



- Velcro-system for one-man-installation



- SMART-control systems



- User-friendly handling

PRINETO Knobbed foil

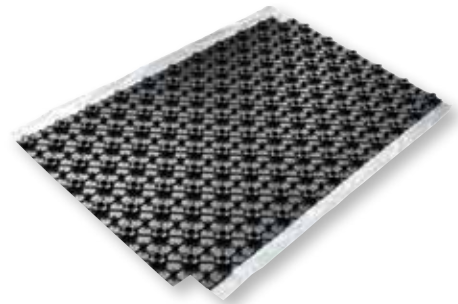

- PRINETO Knobbed foil 12 mm
- PRINETO Underfloor heating pipe 12
- Low profile height from 22 mm to the top edge of screed

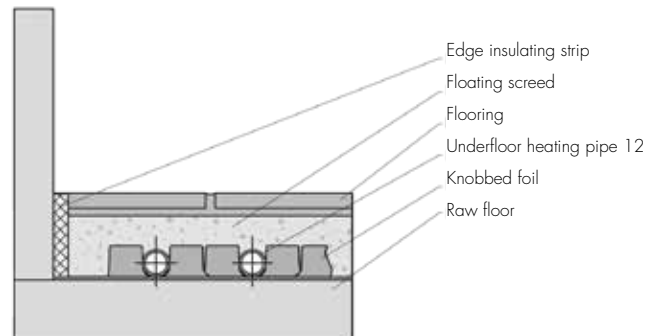

Installation only in combination with a load-bearing surface and with leveling screed.

Knobbed foil 12 mm		
Pipes		12
Suitable screed	Covering	Profile height from
Sopro OFS 543	5 mm	17 mm
Sopro FE 678	20 mm	32 mm
Würth Cerafix 222	10 mm	22 mm
PCI Periplan Extra	10 mm	22 mm
Impact sound reduction		no

PRINETO Knobbed board system

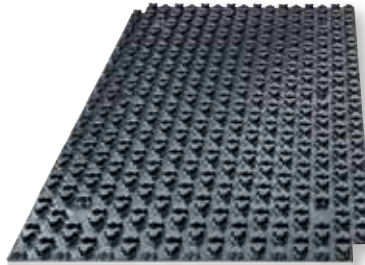

- PRINETO Knobbed Board with 11 mm Insulation
- PRINETO Surface Heating Pipe 14, 17 or Stabil 16 x 2.0
- Installation height from 42 mm to top Edge of Screed (Knobbed Board with 11 mm insulation*)

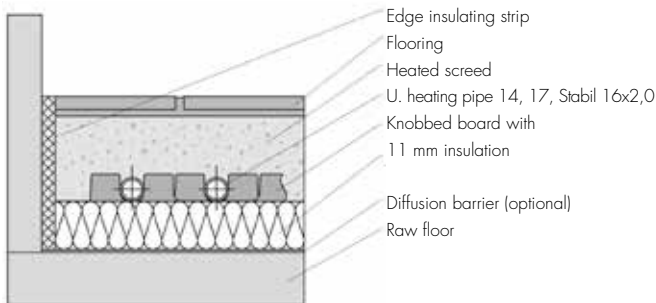

Floating construction with cement screed according to DIN 18560 (45 mm Screed covering over Pipe) or special screeds with corresponding system coverage (see table below).

PRINETO knobbed board		
Pipes	14, 17, UFH Stabil 16 x 2,0	
Suitable screed	Covering	Profile height from
Knauf N440	20 mm*	52 mm*
Würth Cerafix 222	10 mm*	42 mm*
Cement screed acc. DIN 18560	45 mm	70 mm
Impact sound reduction	no	

*only knobbed board with 11 mm insulation

PRINETO Tacker system



- PRINETO Tacker Foil with Thermal Insulation Board 20 and 30 mm, Compressive Stress ≥ 150 kPa
- PRINETO Surface Heating Pipe 14, 17 or Stabil 16 x 2.0
- Installation height from 46 mm to top Edge of Screed (pipe 14)

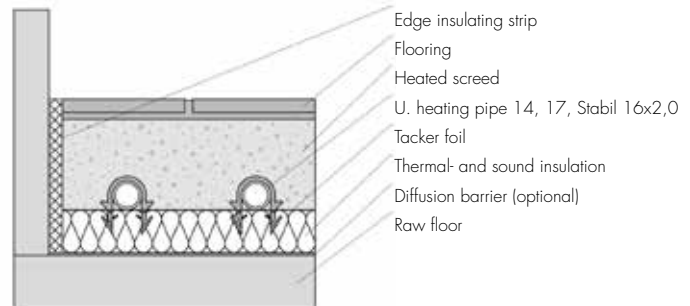

Floating construction with cement screed according to DIN 18560 (45 mm Screed covering over Pipe) or special screeds with corresponding system coverage (see table below).

PRINETO tacker system		
Pipes	14, 17, FBH Stabil 16 x 2,0	
Suitable screed	Covering	Profile height from
Knauf N440	20 mm*	54-57 mm*
Würth Cerafix 222	10 mm*	44-47 mm*
Cement screed acc. DIN 18560	45 mm	79-89 mm
Impact sound reduction	no	

* With 20 mm Insulation, Compressive Stress ≥ 150 kPa

PRINETO Velcro fleece with EPS ECO



- PRINETO Velcro Fleece on Insulation 20 or 30 mm EPS DEO, Compressive Stress ≥ 150 kPa
- PRINETO Velcro Surface Heating Pipe 12, 14, 17 or
- PRINETO Velcro Surface Heating Pipe Stabil 16 x 2,0
- Installation height 44 mm to top Edge of Screed (pipe 12)

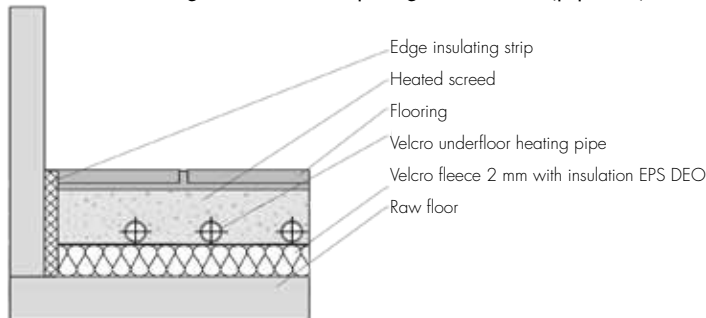

This floor structure is only possible with special screeds listed below with a minimum system coverage.

Velcro fleece with insulation

Pipes	12, 14, 17, FBH Stabil 16 x 2,0	
Suitable screed	Covering	Profile height from
Knauf N440	20 mm*	54-69 mm*
Würth Cerafix 222	10 mm*	44-59 mm*
Impact sound reduction	no	

* Compressive Stress Insulation ≥ 150 kPa

PRINETO Velcro fleece on raw floor

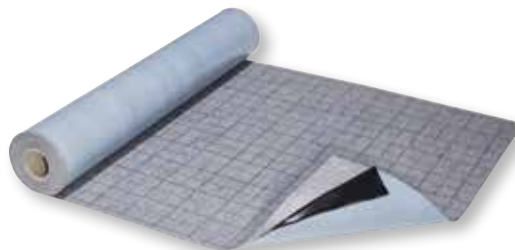

- PRINETO Velcro Fleece on Raw Floor
- PRINETO Velcro Surface Heating Pipe 12, 14, 17 or
- PRINETO Velcro Surface Heating Pipe Stabil 16 x 2.0
- Installation height from 24 mm to top Edge of Screed (pipe 12)

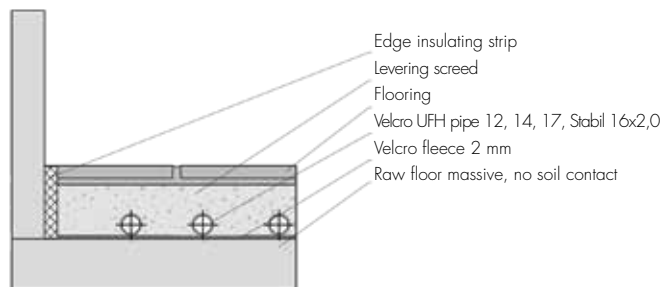

This floor structure is only possible with special screeds listed below with a minimum system coverage.

Velcro fleece on raw floor

Pipes	12, 14, 17, FBH Stabil 16 x 2,0	
Suitable screed	Covering	Profile height from
Knauf N440	20 mm	34-39 mm
Würth Cerafix222	10 mm	24-29 mm
Cement screed acc. DIN 18560	45 mm	59-64 mm
Impact sound reduction	no	

PRINETO Velcro fleece, perforated



- PRINETO Velcro Fleece, perforated
- PRINETO Velcro Surface Heating Pipe 12
- Installation height from 22 mm to top Edge of Screed

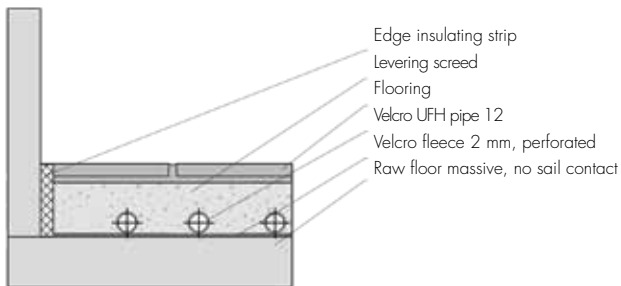

This floor structure is only possible with special screeds listed below with a minimum system coverage.

Velcro fleece, perforated

Pipes	Velcro 12	
Suitable screed	Covering	Profile height from
Knauf N440	8 mm	22 mm
Würth Cerafix222	10 mm	24 mm
Impact sound reduction		no

PRINETO Velcro PE-sheeting



- PRINETO Velcro PE-Sheeting
- PRINETO Velcro Underfloor Heating Pipe 12, 14, 17 or
- PRINETO Velcro Underfloor Heating Pipe Stabil 16 x 2,0
- Installation height from 33 mm to top Edge of Screed (pipe 12)

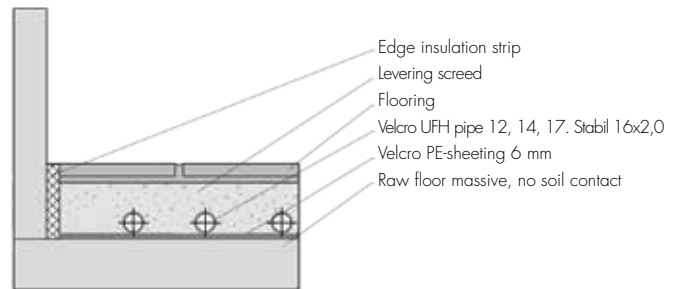

This floor structure is only possible with special screeds listed below with a minimum system coverage.

Velcro PE-sheeting

Pipes	12, 14, 17, FBH Stabil 16 x 2,0	
Suitable screed	Covering	Profile height from
Würth Cerafix222	15 mm*	33-38 mm*
Impact sound reduction		bis 21 dB

* Compressive Stress Insulation ≥ 150 kPa

PRINETO Dry system



- PRINETO Grooved/U-Turn elements 30 mm
- PRINETO Underfloor Heating Pipe Stabil 16 x 2.0
- Fermacell dry screed 25 mm or Knauf Brio 18 mm

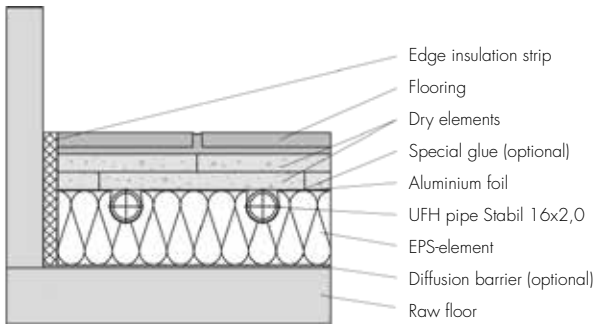

Height 55 mm to the top Edge of the Screed (with Fermacell)
 Construction height 45 mm to top Edge of Screed (with Knauf Brio 18)

Dry system

Pipes	UFH Stabil 16 x 2,0	
Suitable screed	Covering	Profile height from
Knauf Brio 18	18 mm	48 mm
Fermacell	25 mm	55 mm
Impact sound reduction	no	

Notes

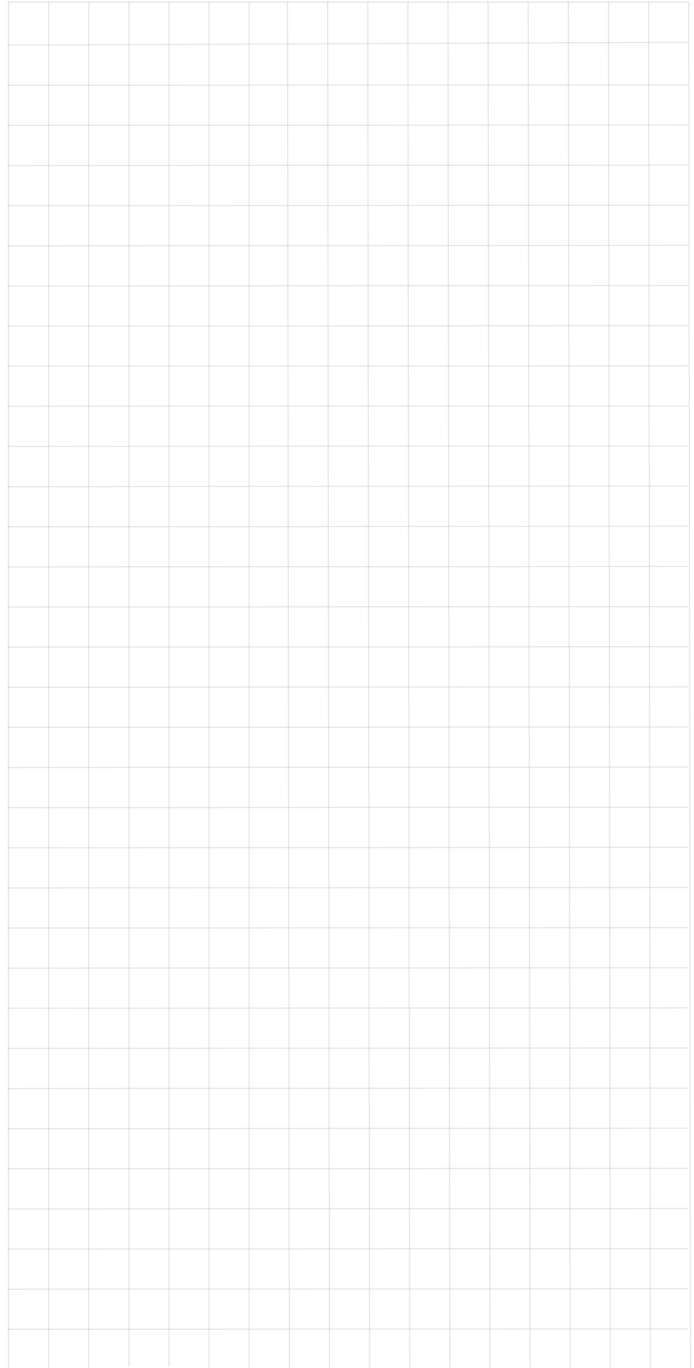



IVT HIGHLIGHTS

- ✓ Subsidiary of the global Würth Group
- ✓ Modern production facilities in Germany
- ✓ Direct sales without intermediaries
- ✓ 24 h delivery service in Germany and Austria
- ✓ Competent expert advisors on site
- ✓ Site instruction and supervision
- ✓ Design Support
- ✓ B2B Online-Shop

Status 06/2023
Reprint, also in extracts only with permission
© by IVT GmbH & Co. KG Printed in Germany

IVT GmbH & Co. KG

 Gewerbering Nord 5, 91189 Rohr, Germany

 Order-Hotline: +49 9876 9786-40
Technical Support: +49 9876 9786-60

 export@ivt-group.com

 ivt-group.com

